

# HD SERIES - CYLINDERS

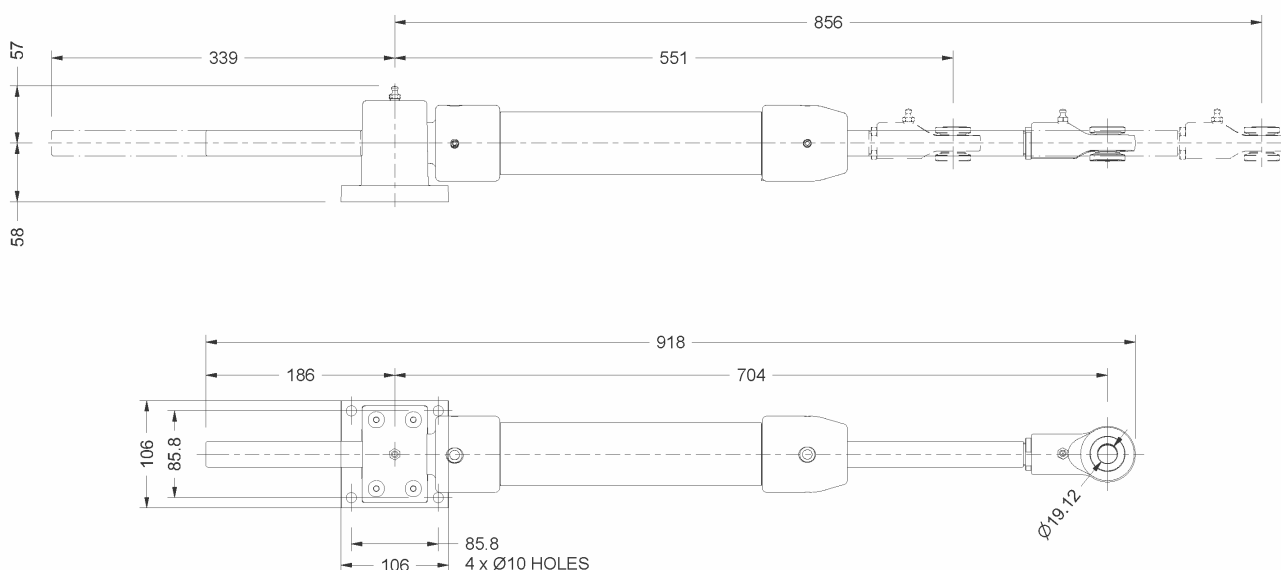

# MODEL HD200-12

## NOMINAL DIMENSIONS



NOTE: dimensions are nominal only and subject to change without notice. These dimensions should be used only as a general guide to the footprint of space required. Final drilling and fitting of the cylinder should only done once the unit has been delivered and on-site.

Bore diameter:- 2"  
Stroke - 12" ( 304mm)  
Volume - 463cc  
Tiller length - 265mm

Cylinder thrust @ 1000psi = 1069Kgf  
Rudder torque @ 1000psi @ 0 degrees = 284KgM  
Rudder torque @ 1000psi @ 35 degrees = 233KgM

Maximum Working Pressure - 1500psi