

HD SERIES - HELM UNITS

Full feed-back type helm unit
 No in-built lock-valve
 Stainless steel steering wheel shaft



Models
 103,104 & 105
 with parallel shaft as standard
 Also available in international
 taper shaft or Lewmar Taper
 shaft versions

Models
 106 & 107
 with parallel shaft as standard.
 Lewmar Taper also available

MODELS 103, 104, 105, 106 & 107

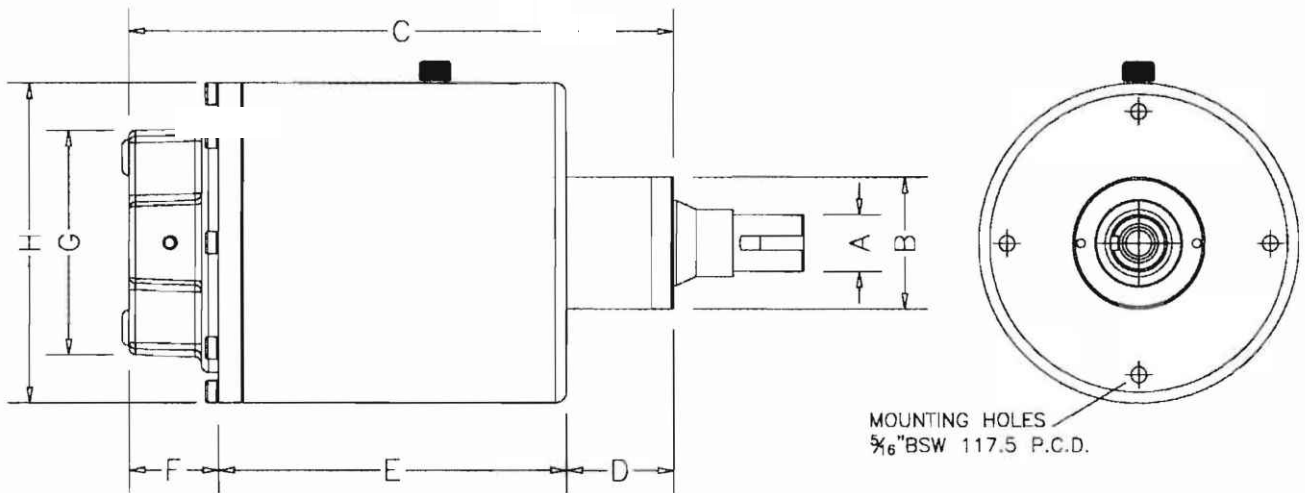

Model 103,104,105,106 &107 HELM PUMP DIMENSIONS

MODEL	A	B	C	D	E	F	G	H
103	T	59	303	48	156	40	102	143
104	P	59	303	48	156	40	102	143
105	P	59	303	48	156	40	102	143
106	P	59	334	48	182	46	112	170
107	P	59	334	48	182	46	112	170

T = 3/4" dia TAPER(1" per ft) SHAFT - 3/4"x3/16" WOODRUFF KEY

P = 1" dia PARALLEL SHAFT - 1/4"x 1" SQUARE KEY

DISPLACEMENTS

Model 103 - 2.00 cu ins (35cc) per rev
 Model 104 - 2.60 cu ins (43cc) per rev
 Model 105 - 5.20 cu ins (86cc) per rev

Model 106 - 7.5 cu ins (125cc) per rev
 Model 107 - 10 cu ins (165cc) per rev

Maximum Working Pressure - 1000psi Design Pressure - 1500psi