

212PRO SLAVE CYLINDER

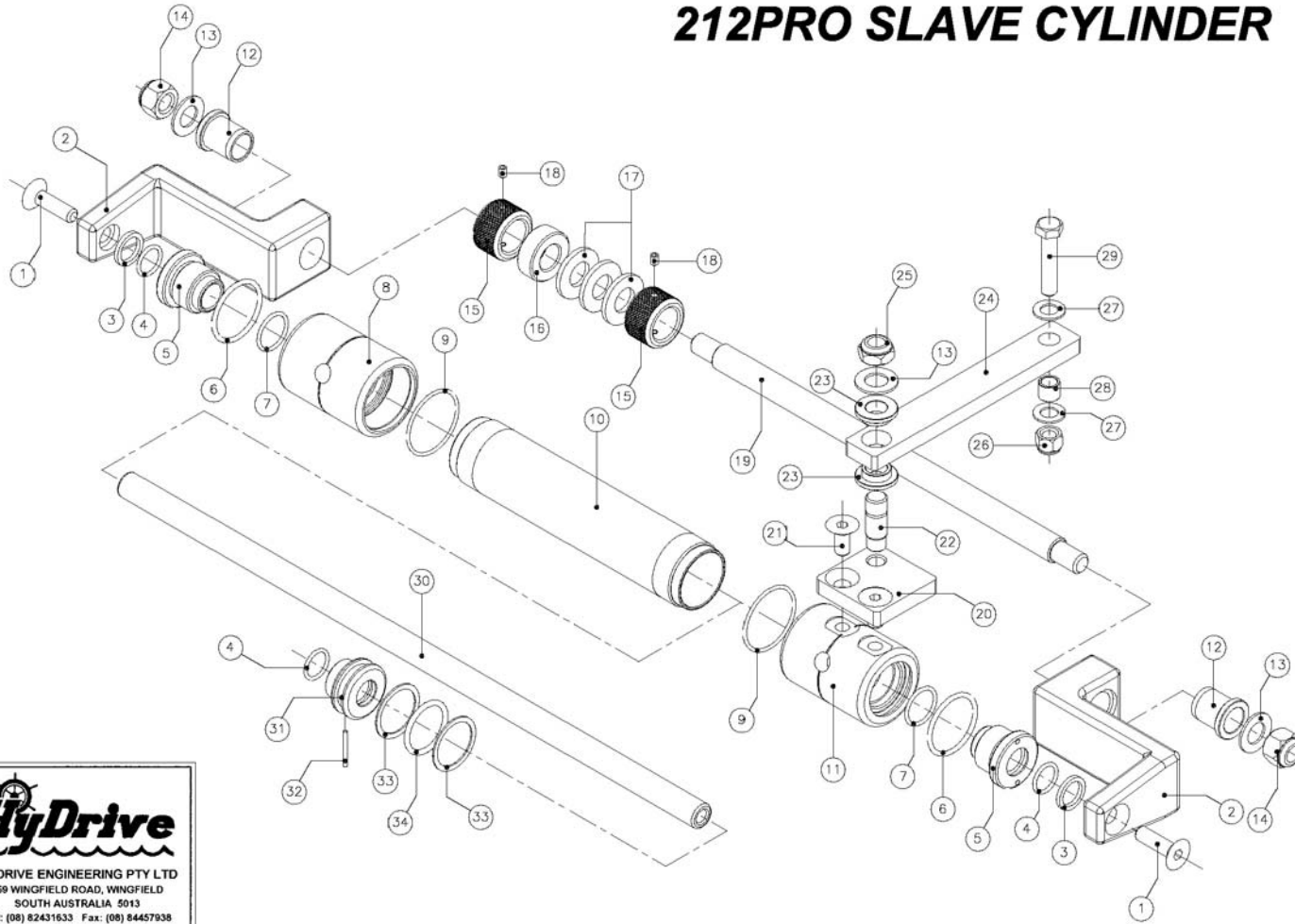

212PRO SLAVE CYLINDER

NUMBER	DESCRIPTION	PART NUMBER	QTY
1	3/8" UNFx 1 1/4" 304 S/S	SC-10156	2
2	212 PRO BULL HORN	BH-6376	2
3	ROD WIPER SEAL	WS-10252	2
4	O-RING PISTON ROD	N7-114	3
5	GUIDE BUSH	BU-6369	2
6	O-RING GUIDE BUSH	N7-220	2
7	O-RING ENDCAP-GUIDE BUSH	N7-216	2
8	END CAP FREE END	EC-6371	1
9	O-RING END CAP	N7-128	2
10	CYLINDER SLAVE 212BH	CY-6370	1
11	END CAP MOUNTING END	EC-6372	1
12	HEADER BUSH	BU-6158	2
13	WASHER 304 1/2x1x16G	WA-10136	3
14	1/2" UNC NYLOC 304 S/S NUT	NU-10134	2
15	ADJUSTING NUT TILT TUBE	NU-6172	2
16	SPACER BUSH 12.0mm	BU-6173	1
17	SPACER BUSH 3.0mm	BU-6156	3
18	1/4 UNC 304 S/S G/SCREW	SC-10137	2
19	TILT TUBE ROD 210BH	SH-6164	1
20	MOUNTING TILLER PLATE	MO-6341	1
21	M10x20 HEX COUNTER SINK	SC-10155	2
22	STUD MOUNTING PLATE	ST-6318	1
23	PIVOT BUSH TILLER ARM	BU-6317	2
24	TILLER ARM	TA-6318	1
25	1/2"UNFx8.0 304 S/S NUT	NU-10185	1
26	3/8"UNF NYLOC 316 S/S NUT	NU-10133	1
27	3/8x3/4x18G 304 S/S WASHER	WA-10136	2
28	BUSH TILLER ARM BOLT	BU-6319	1
29	3/8UNFx1 3/4 304S/S BOLT	SC-10155	1
30	PISTON ROD 212BH	PR-6373	1
31	PISTON 212BH	PI-6374	1
32	DOWEL PIN 3/16"x1 1/4"	DO-10166	1
33	BACK UP WASHER	BW-10100	2
34	O-RING PISTON	N7-216	1